

ADDENDUM

TO THE

BUSHBABY ASSEMBLY

MANUAL

FUSELAGE MANUAL

AFFECTED PAGES

PAGE

F3

F4

F7

F9

F11

F12

F14

F14

F16

F18

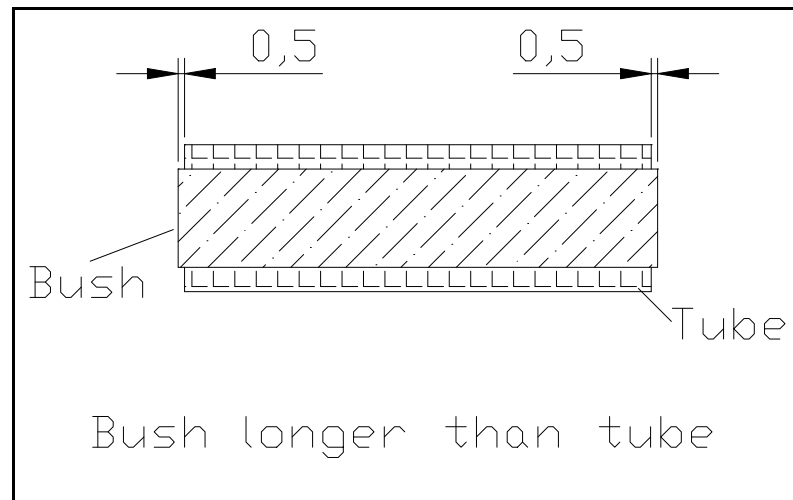
PART F3

Bronze bush installation

NOTE:	The part must pivot around the Bronze Bush i.e. The bolt must remain stationary
-------	---

PAGE F4:

1.4 SEAT BELT MOUNTING TABS

All seat belt and harness tabs are pre drilled. There are now only two shoulder harness tabs instead of three.

PAGE F7

STEP 2

2. We no longer recommend installing the brake cable under the floor as the cable has to make to a sharp bend, thus making the brakes difficult to operate.

PAGE F9

The FBC-1 bell crank has change slightly, now that it is laser cut

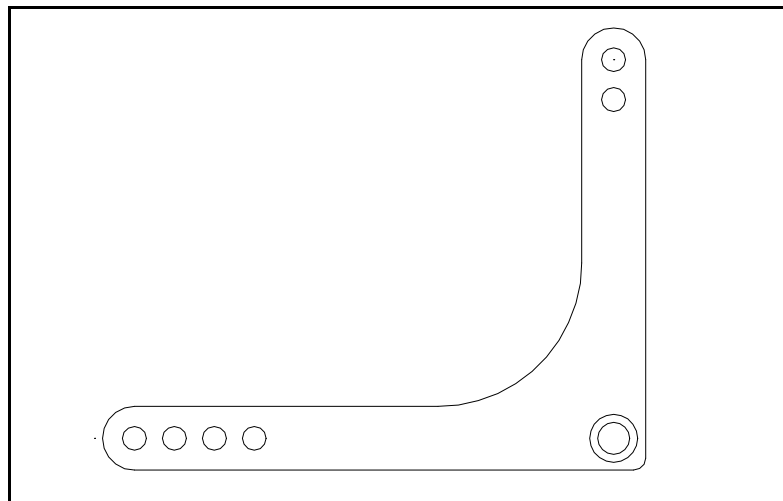

FBC-1

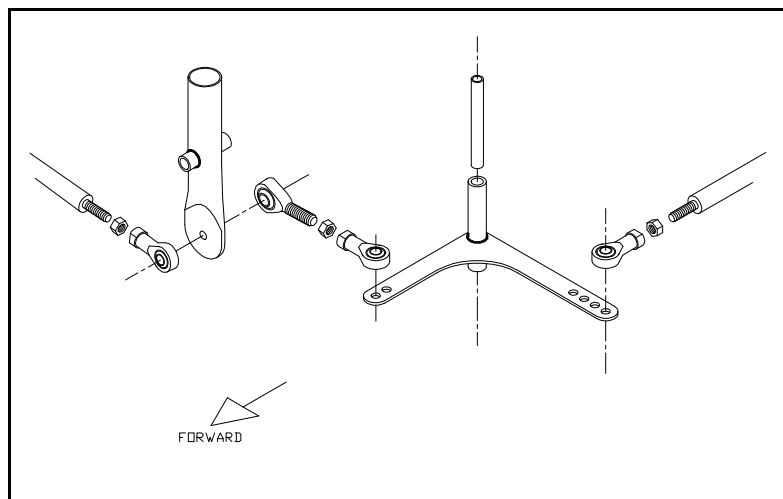

FBC-1 ASSEMBLY

3. Manual reads FCS-2 should be FCT-2

PAGE F11

6. The FCT-7 is not 16mm but \varnothing 25mm aluminium. The 6mm rod-end is screwed in as far as possible

WARNING:

The rod-end installed in the FCT-8 fitting is not to be used as an adjuster. If the rod end is not screwed in fully, it could pull out of the aluminium fitting under severe pressure.

PAGE F12

3.2 FLAP CONTROL

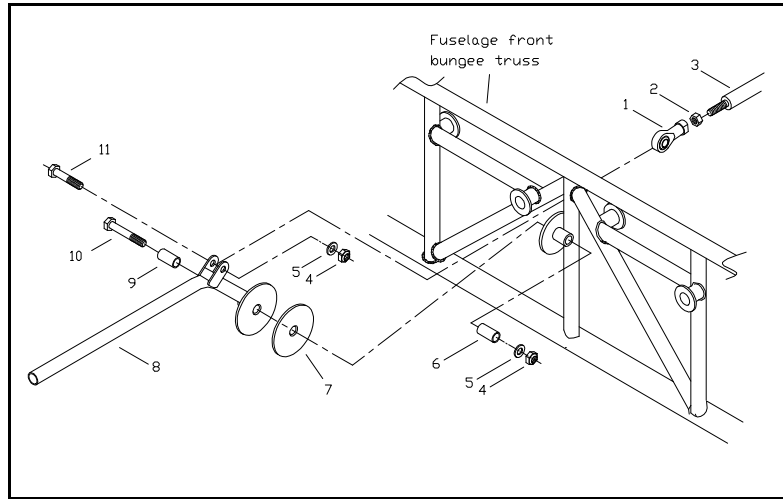

FLAP HANDLE ASSEMBLY

3.3 FLAP AND AILERON MIXERS

1. Part FRB-4 should read FBR-4

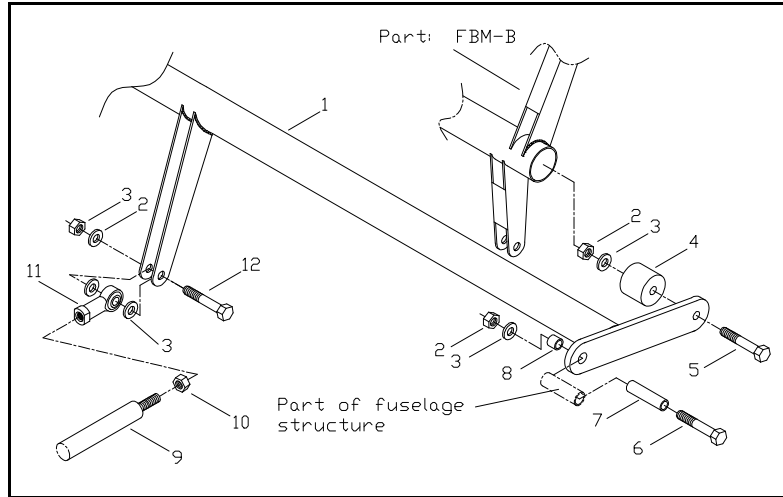

FBM- A & FBM-B ASSEMBLY

PAGE F14/15

2. Sketch: the bolts holding the stabilizer to the frame now fit from left to right, not front to rear as shown in sketch. Bolts are now longer.

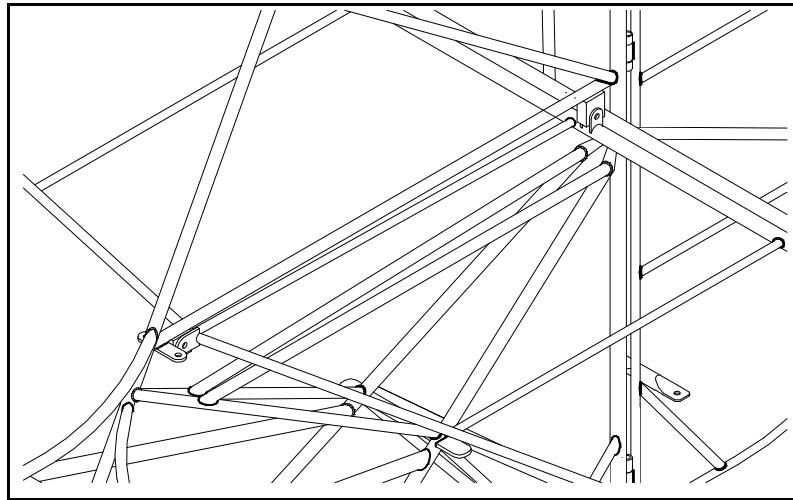

Tail plane tabs

PAGE 15

6. Lower sketch. Rear stabilizer strut is fitted as per sketch, front portion of v-strut has rod –end bearing, to allow for incidence setting of stabilizer.

PAGE F16

FEV-1 is secured with Circlip or safety wire in the provided groove. The FCT-7 tube must be a loose fit, ensuring that it does not bind.

PAGE F18

FRP-5 & FRP-5 are now laser cut. FRP-2 does not need bending.